

STATE OF COLORADO, OFFICE OF THE STATE ENGINEER

RECEIVED

JUN 04 98

WATER RESOURCES STATE ENGINEER

11-23-92

1. WELL PERMIT NUMBER 167475-A 167475-A

2. OWNER NAME(S) Mark Dunn
Mailing Address 372 Old Corral Road
City, St. Zip Bailey, Colorado 80421
Phone (303) 838-1248

3. WELL LOCATION AS DRILLED: NE 1/4 SE 1/4, Sec. 9 Twp. 7 S, Range 71 W
DISTANCES FROM SEC. LINES: 1950 ft. from South Sec. line. and 540 ft. from Was Sec. line.
SUBDIVISION: LOT BLOCK FILING(UNIT)
STREET ADDRESS AT WELL LOCATION: 29700 SouthSunset Trail

4. PUMP DATA: Type Submersible Installation Completed Oct. 16, 1992
Pump Manufacturer Goulds Pump Model No. 7EH10422
Design GPM 7 at RPM 3640, HP 1, Volts 230, Full Load Amps
Pump Intake Depth 385 Feet, Drop/Column Pipe Size 1 Inches, Kind P.V.C.

ADDITIONAL INFORMATION FOR PUMPS GREATER THAT 50 GPM:

TURBINE DRIVER TYPE: Electric Engine Other
Design Head feet, Number of Stages, Shaft size inches.

5. OTHER EQUIPMENT:

Airline Installed Yes No, Orifice Depth ft. Monitor Tube Installed Yes No, Depth ft.
Flow Meter Mfg. Meter Serial No.
Meter Readout Gallons, Thousand Gallons, Acre feet, Beginning Reading

6. TEST DATA: See item #9 Check box if Test data is submitted on Supplemental Form.

Total Well Depth 402 ft Date 10-15-92
Static Level 35 ft Time 3 P.M.
Date Measured 10-15-92 Rate (GPM) 100+ gpm
Pumping Lvl. 392 ft

7. DISINFECTION: Type H. T. H. Amt. Used 100 P.P.M.

8. Water Quality analysis available. Yes No

9. Remarks For well produciton, see well drillers report
Pump is capable of pumping 762 gallons per hour 0 at o P.S.I.
This is not well produciton by pump capacity

10. I have read the statements made herein and know the contents thereof, and that they are true to my knowledge. [Pursuant to Section 24-4-104 (13)(a) C.R.S., the making of false statements herein constitutes perjury in the second degree and is punishable as a class 1 misdemeanor.]

CONTRACTOR James Drilling Company Phone (303) 420-5181 Lic. No. 1134.
Mailing Address 6235 West 56th Avenue Arvada, Colorado 80002

Name/Title (Please type or print) Signature Date
Michael Keaton, President [Signature] 12-16-92

WELL CONSTRUCTION AND TEST REPORT
STATE OF COLORADO, OFFICE OF THE STATE ENGINEER

For Office Use only

RECEIVED

JAN 04 '93

WATER RESOURCES
STATE ENGINEER
COLO.

11-23-92

1. WELL PERMIT NUMBER 167475-A

2. OWNER NAME(S) Mark Dunn
Mailing Address 372 Old Corral Road
City, St. Zip Bailey, Colorado 80421
Phone (303) 838-1248

3. WELL LOCATION AS DRILLED: NE 1/4 SE 1/4, Sec. 9 Twp. 7 S, Range 71 W
DISTANCES FROM SEC. LINES:
1950 ft. from South Sec. line. and 540 ft. from East Sec. line. OR
(north or south) (east or west)
SUBDIVISION: LOT BLOCK FILING(UNIT)
STREET ADDRESS AT WELL LOCATION: 29700 South Sunset trail

4. GROUND SURFACE ELEVATION Unknown ft. DRILLING METHOD Air
DATE COMPLETED Oct. 15, 1992. TOTAL DEPTH 402 ft. DEPTH COMPLETED 402 ft.

5. GEOLOGIC LOG:

Depth	Description of Material (Type, Size, Color, Water Location)
0 14	Overburden
14 35	Red granite
35 45	Med. hard, red granite
45 80	Gray granite
80 84	Red quartz & granite xxx
84 271	Gray granite, layers of red
271 276	Red quartzsite xxx
276 371	Mixed red gray granite
371 375	Red quartzsite xxx
375 402	Gray granite, some red

REMARKS:

6. HOLE DIAM. (in.)

From (ft)	To (ft)
0	21
21	402

7. PLAIN CASING

OD (in)	Kind	Wall Size	From(ft)	To(ft)
6 5/8	Steel	.188	0	21
4.5	P.V.C.	200	10	360

PERF. CASING: Screen Slot Size:
4.5 P.V.C. 200 360 402

8. FILTER PACK:
Material _____
Size _____
Interval _____

9. PACKER PLACEMENT:
Type Rubber
with Bentonite
Depth 60 ft.

10. GROUTING RECORD:

Material	Amount	Density	Interval	Placement
Cement	188#	14.4#	6'	21'

11. DISINFECTION: Type H. T. H. Amt. Used 100 P.P.M.

12. WELL TEST DATA: Check box if Test Data is submitted on Supplemental Form.
TESTING METHOD Air
Static Level 35 ft. Date/Time measured 10-15-92 3P.M., Production Rate 100+ gpm.
Pumping level 392 ft. Date/Time measured _____, Test length (hrs.) 2
Remarks _____

13. I have read the statements made herein and know the contents thereof, and that they are true to my knowledge. [Pursuant to Section 24-4-104 (13)(a) C.R.S., the making of false statements herein constitutes perjury in the second degree and is punishable as a class 1 misdemeanor.]

CONTRACTOR James Drilling Company Phone (303) 420-5181 Lic. No. 1134
Mailing Address 6235 West 56th avenue Arvada, Colorado 80002

Name/Title (Please type or print) <u>Michael Keaton, President</u>	Signature 	Date <u>12-16-92</u>
---	---	-------------------------

OFFICE OF THE STATE ENGINEER
COLORADO DIVISION OF WATER RESOURCES

818 Centennial Bldg., 1313 Sherman St., Denver, Colorado 80203
(303) 866-3581

APPLICANT

WELL PERMIT NUMBER		167475		A	
DIV. 1	CNTY. 30	WD 80	DES. BASIN	MD	

Lot: Block: Filing: Subdiv:

MARK DUNN
372 OLD CORRAL RD
BAILEY CO 80421

(303)838-1248

APPROVED WELL LOCATION
JEFFERSON COUNTY

NE 1/4 SE 1/4 Section 9
Twp 7 S RANGE 71 W 6th P.M.

DISTANCES FROM SECTION LINES

1950 Ft. from South Section Line
540 Ft. from East Section Line

PERMIT TO CONSTRUCT A WELL

ISSUANCE OF THIS PERMIT DOES NOT CONFER A WATER RIGHT
CONDITIONS OF APPROVAL

- 1) This well shall be used in such a way as to cause no material injury to existing water rights. The issuance of the permit does not assure the applicant that no injury will occur to another vested water right or preclude another owner of a vested water right from seeking relief in a civil court action.
- 2) The construction of this well shall be in compliance with the Water Well Construction and Pump Installation Rules 2 CCR 402-2, unless approval of a variance has been granted by the State Board of Examiners of Water Well Construction and Pump Installation Contractors in accordance with Rule 17.
- 3) Approved pursuant to CRS 37-92-602(3)(c) for the relocation of an existing well, permit no. 167475. The old well must be plugged and abandoned according to the Water Well Construction and Pump Installation Rules within ninety (90) days of completion of the new well. **The enclosed well abandonment report form must be completed affirming that the old well was plugged and abandoned.**
- 4) The use of ground water from this well is limited to ordinary household purposes inside two (2) single family dwellings, the watering of domestic animals, and the irrigation of not more than one of home gardens and lawns. This well is to be on a 40 acre parcel, located at 29700 S. Sunset Trail, Jefferson County.
- 5) The maximum pumping rate shall not exceed 15 GPM.
- 6) The average annual amount of ground water to be withdrawn shall not exceed 1 acre-foot.
- 7) This well shall be constructed not more than 200 feet from the location specified on this permit.
- 8) Verbal approval 92VE356, was given for the construction of this well on September 25, 1992.

RL
11-20-92

APPROVED
TLC

Hal D. Simpson
State Engineer

Lanham J. Lamberson
By

Receipt No. 0344695B

DATE ISSUED NOV 23 1992

EXPIRATION DATE NOV 23 1994

(5) THE LOCATION OF THE PROPOSED WELL and the area on which the water will be used must be indicated on the diagram below. Use the CENTER SECTION (1 section, 640 acres) for the well location.

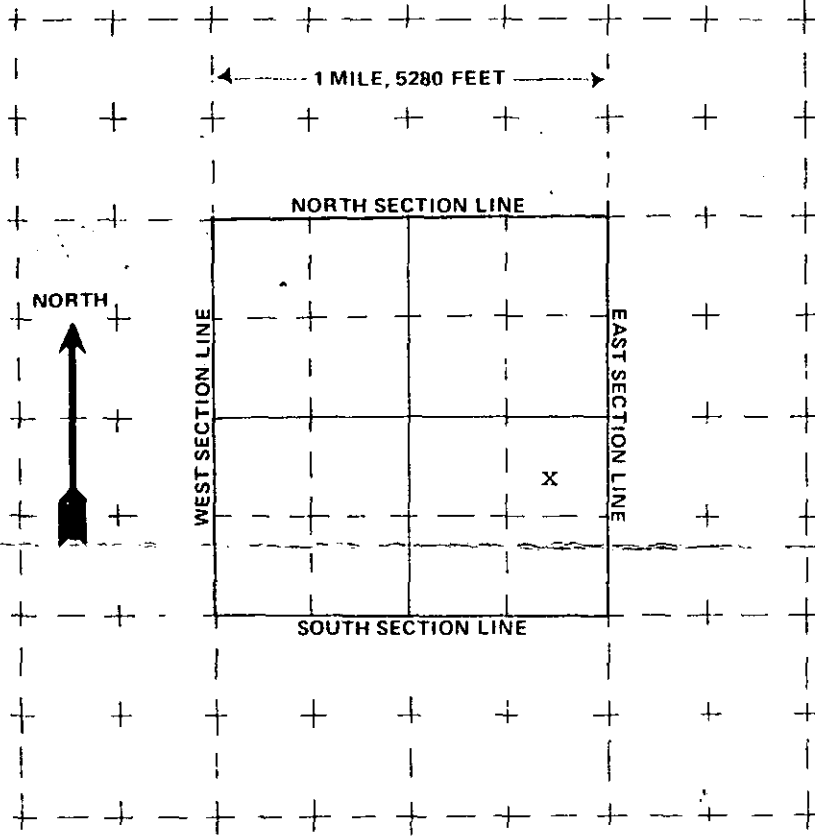

The scale of the diagram is 2 inches = 1 mile
Each small square represents 40 acres.

WATER EQUIVALENTS TABLE (Rounded Figures)

An acre-foot covers 1 acre of land 1 foot deep
 1 cubic foot per second (cfs) . . . 449 gallons per minute (gpm)
 A family of 5 will require approximately 1 acre-foot of water per year.
 1 acre-foot . . . 43,560 cubic feet . . . 325,900 gallons.
 1,000 gpm pumped continuously for one day produces 4.42 acre-feet.

(6) THE WELL MUST BE LOCATED BELOW by distances from section lines.

1950 ft. from South sec. line
(north or south)
 540 ft. from East sec. line
(east or west)

LOT _____ BLOCK _____ FILING # _____
 SUBDIVISION _____ Tract _____

(7) TRACT ON WHICH WELL WILL BE LOCATED Owner: Mark Dunn
 No. of acres 40 Will this be the only well on this tract? Yes

(8) PROPOSED CASING PROGRAM

Plain Casing
 6 5/8 in. from +1 ft. to 20 ft.
 Perforated casing
 4.5 in. from 10 ft. to 100 ft.
 4.5 in. from 100 ft. to 200 ft.
 _____ in. from _____ ft. to _____ ft.

(9) FOR REPLACEMENT WELLS give distance and direction from old well and plans for plugging it:

40 ft. west of old well, old well will be plugged according to rules and regulations

(10) LAND ON WHICH GROUND WATER WILL BE USED:

Owner(s): Mark Dunn No. of acres: 40
 Legal description: NE 1/4, SE 1/4, Sec. 7 S, R 71W, 6th P.M. Jefferson County

(11) DETAILED DESCRIPTION of the use of ground water: Household use and domestic wells must indicate type of disposal system to be used.

Domestic use, household, water of 1 acre and domestic animals.
Septic and leachfield

(12) OTHER WATER RIGHTS used on this land, including wells. Give Registration and Water Court Case Numbers.

Type or right	Used for (purpose)	Description of land on which used
<u>None</u>		

(13) THE APPLICANT(S) STATE(S) THAT THE INFORMATION SET FORTH HEREON IS TRUE TO THE BEST OF HIS KNOWLEDGE.

Mark Dunn
 SIGNATURE OF APPLICANT(S)

COLORADO DIVISION OF WATER RESOURCES EMERGENCY VERBAL REQUEST INFORMATION

to be completed in INK

DIV _____, WD _____, BAS _____, MD _____, CO _____

verbal receipt # 19810

DATE CALLED IN 9, 23, 92 (fax)

Approval # 92 VE 356

MAKING BY _____ NAME OF CALLER _____
(INITIALS)

Date Approval Given 9/25/92; Given By PAV
(INITIALS)

APPROVAL GIVEN TO (name, company) DEWA James Drilling

APPLICANT: Mark Duman

CONTRACTOR: James Drilling Co.

ADDRESS: 372 Old Corral Rd
Bailey CO 80921

COMPANY ADDRESS: 6235 W 56th Ave, Denver

LIC #: 1134; phone: 420 5181

PHONE: 838-1248 (H) / (O)

APPL. RECEIPT # & DATE _____

TYPE OF WELL: Domestic

PERMIT # LR/REPL; CASE # _____

PROPOSED LOCATION OF (new) REPLACEMENT WELL:

NE 1/4, SE 1/4, Sec. 9, Twp. 7S, Rng. 71W, 6th P.M.;

DIST. 1250 from N/S sec. line, 540 from E/W sec. line; County Jefferson

distance & direction from old well to new well site 70 ft west; DEEPEN (circle if deepen)

Subdv. info.: lot(s) _____ blk. _____ flg. _____ subdv. _____

Additional parcel info. / or gen'l. comments: _____

REASON FOR EMERGENCY: OUT OF WATER OCCUPIED RESIDENCE? (yes) / no STOCK ON PASTURE CROP IRRIGATION
(circle) OTHER Well caved in

CASING/AQUIFER INFO: DEPTH OF OLD WELL? 100; PROPOSED DEPTH? 200; AQUIFER? fractured granite
CASING? plain surface to 100 perf. 100-200 DATE TO START? 9/25/92

FIELD INSP. REQ.? (YES) / (NO) over for field inspection report information; called in? - date 1 1

EVALUATING STAFF COMMENTS: _____

CONDITIONS OF APPROVAL: Submit Late registration & Replacement application w/ \$60 in 10 days ^{referencing} this verbal.
Old well must be plugged & abandoned per Rules w/in 60 days of construction abandonment
report submitted. Verbal approval expires 60 days from issuance date.

EVALUATED BY: PAV; DATE: 9/23/92; APPROVED BY: B.E. DeBene; DATE: 9-23-92
(INITIALS) (SIGNATURE)

PLEASE complete this form in INK

Driller Unknown at this time

VERBAL appl. receipt no(s) SEP 11 '92

DATE OF INSPECTION: 1 WD 80 9 18 1 92

WATER RESOURCES STATE ENGINEER COLO.

APPLICANT: Retta Dunn person contacted if not applicant:

ADDRESS: 372 Old Carral Rd. Bailey Co. 80421 W.C. name & phone #: Roger A. Alodzik 838-8840

PHONE: H 838-1248 W 349-7367

EXISTING WELL LOCATION: NE 1/4, SE 1/4, Sec. 9, Twp. 7S, Rng. 7W, 6 P.M.; DIST. 1950 from N 1/2 S sec. line, 500 from E 1/2 sec. line; County Jefferson (if repl., give dist. & dir. to new well site -)

Describe type of existing well: DRILLED, HAND DUG, SPRING WELL, GALLERY WELL, GRAVEL PIT, OTHER

how many other wells are located on this parcel? None use?

are they registered? permit/case #(s)?

DATE WELL CONSTRUCTED 1940's DATE OF FIRST USE 1940's EST. PUMPING RATE gpm

TOTAL # OF ACRES IN THIS TRACT/PARCEL 35-40 ACRES

Additional subd/parcel info.

USE OF WELL:

- household use in (indicate how many) 2 single family dwelling(s)
watering of poultry and/or domestic animals
watering of livestock on a farm or ranch
is this a feed lot?
(it is important to specify estimated historic lawn/garden irr.) irr. 1 acre square feet/acre of lawn and/or garden
fire protection
commercial - drinking & san. only?
other (write details in "comments" section)

WERE THE USES CHECKED ABOVE INITIATED PRIOR TO MAY 8, 1972? NOTE: IF ANY CHANGE IN THE HISTORIC USE OF THIS WELL HAS OCCURRED SINCE MAY 8, 1972, please indicate the date(s) the use changed, and discuss this change/and/or expansion of the current/proposed use in the "comments" section of this form

completing inspection for NON-EXEMPT USES, use comments section below (include case #, # acres irr. if applicable, etc.)

Report taken by: (Initials); dated: 1 1; called in by: Roger A. Alodzik

Additional comments and/or information: well is dry now